

# CP-4120 CHIPPING HAMMER

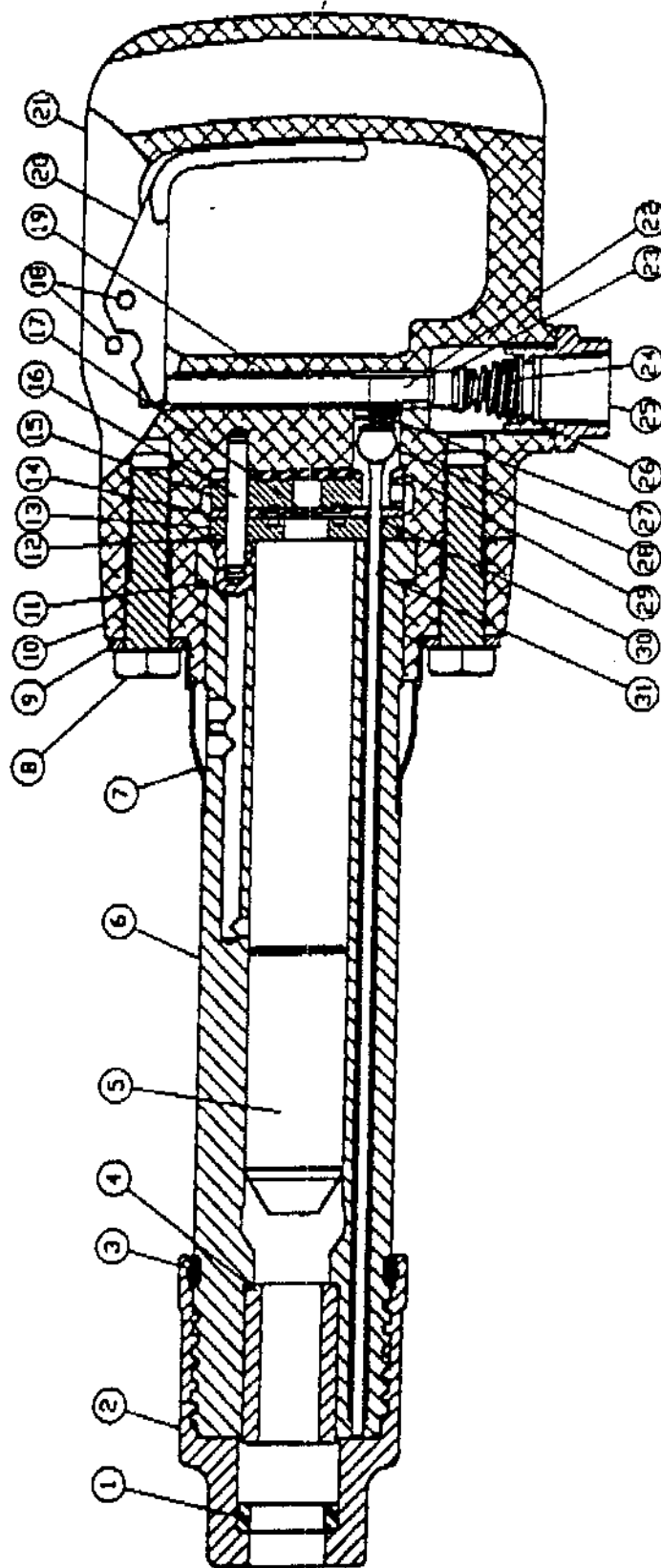

For Parts Call Tools Renewed (800) 247-3639 Fax (860) 665-9821

CP-4120 SIMPLATE HEAVY CHIPPING HAMMERS Model "A" & "U"

<u>Index No.</u>	<u>Part No.</u>	<u>Description</u>	<u>No. Req'd</u>	<u>Index No.</u>	<u>Part No.</u>	<u>Description</u>	<u>No. Req'd</u>
1	P144139	Buffer-Chisel	1	13	P144142	Lid-Lower-Valve	1
2	P144137	Retainer-Chisel	1	14	P144141	Case-Valve	1
3	F035269	Ring-Retainer	1	15	P144140	Lid-Upper-Valve	1
4	P001550	Bushing-Chisel(Rd)	1	16	P144147	Pin-Dowel (2)	2
	P001551	Bushing-Chisel(Hex)	1	17	P142921	Valve-Cycling	1
5	P114386	Piston (1" Str)	1	18	R133757	Pin-Thr. Lever (2)	2
	P118662	Piston (2"/3" Str)	1	19	P144138	Bushing-Thr. Valve	1
	P118678	Piston (4" Str)	1	20	F815167	Lever-Throttle	1
6	P144279	Cylinder, 1" (Rd)	1	21	P144134	Handle	1
	P144280	Cylinder, 1" (Hex)	1	22	P144202	Valve-Throttle	1
	P144281	Cylinder, 2" (Rd)	1	23	P083071	O-Ring (-011)	1
	P144282	Cylinder, 2" (Hex)	1	24	C036909	Strainer-Air	1
	P144283	Cylinder, 3" (Rd)	1	25	C092292	Bushing-Inlet	1
	P144284	Cylinder, 3" (Hex)	1	26	C077054	Spring-Thr. Valve	1
	P144285	Cylinder, 4" (Rd)	1	27	P144144	Spring-Shut-Off	1
	P144286	Cylinder, 4" (Hex)	1	28	C043154	Valve-Shut-Off	1
7	P071355	Deflector-Exhaust	1	29	P144143	Seat-Shut-Off	1
8	P144146	Screw-Cap	2	30	C087316	O-Ring (-006)	1
9	P144782	Washer,Nord-Lock(2per bolt,camface to camface)	4	31	P144205	Rod-Shut-Off (1" Str)	1
					P144204	Rod-Shut-Off (2" Str)	1
10	P144136	Flange-Cylinder	1		P144145	Rod-Shut-Off (3" Str)	1
11	P144153	Ring-Clamp	1		P144203	Rod-Shut-Off (4" Str)	1
12	C100569	O-Ring (-033)	1	2	P144441	Retainer (for oval collar chisel only)	1

Chisel Types

P144267-9" Moil Point	.680 RD Shank, Rd Collar
P144268-12" Moil Point	.680 RD Shank, Rd Collar
P144271-9" Flat Chisel	.680 RD Shank, Rd Collar
P144272-12" Flat Chisel	.680 RD Shank, Rd Collar
P144269-9" Moil Point	.580 Hx Shank, Rd Collar
P144270-12" Moil Point	.580 Hx Shank, Rd Collar
P144273-9" Flat Chisel	.580 Hx Shank, Rd Collar
P144274-12" Flat Chisel	.580 Hx Shank, Rd Collar

For Parts Call Tools Renewed (800) 247-3639 Fax (860) 665-9821