

# CHICAGO PNEUMATIC MODEL 117 PAVING BREAKER

For Parts And Accessories

Tools Renewed Inc  
Tel: 800-247-3639 Fax: 860-665-9821  
Email: sales@toolsrenewed.com

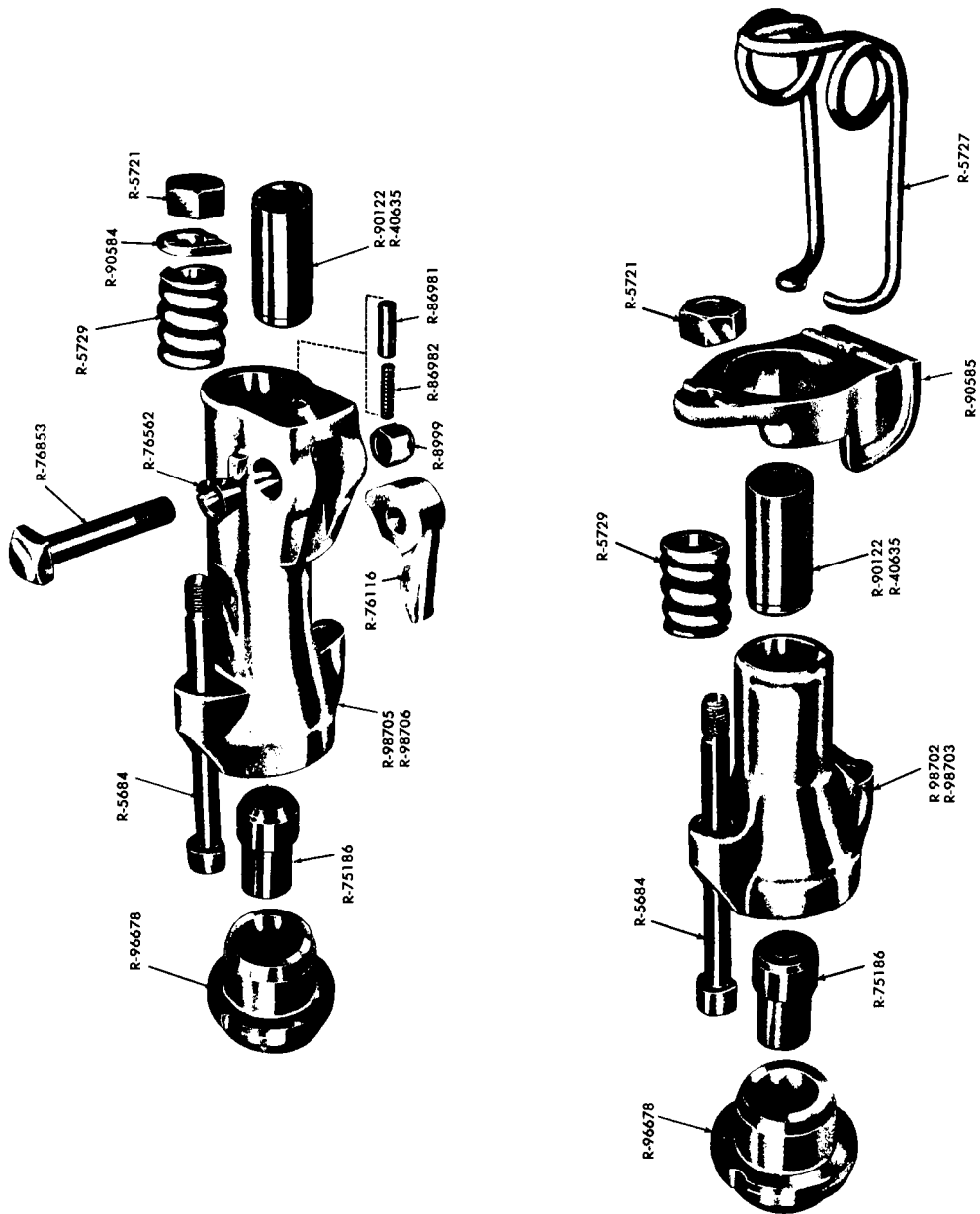

# Chicago Pneumatic Model 117 Paving Breaker

Tools Renewed Inc  
Tel: 800-247-3639  
Fax: 860-665-9821  
Email: sales@toolsrenewed.com

PART NO.	REF. NO.	NAME OF PART	PART NO.	REF. NO.	NAME OF PART
<b>HANDLE</b>			R96678	2738	Anvil Collar
R4976	2703	Oil Regulating Plug	R75186	2715	Anvil Piston
R2164	2702	Backhead Bolt Nut	<b>FRONTHEAD</b>		
R85169	2725	Backhead Bolt Washer	R5684	2704	Fronthead Bolt Bare
R5712	2705	Throttle Lever	R90122	2729	1 1/4 Hex. Bushing
R75139	2717	Backhead Bolt	R40635	2730	1 1/4 Hex. Bushing
R5713	2706	Throttle Lever Pin	R98725	2746	Fronthead 1 1/4
R5716	2707	Rubber Grip	R98706	2739	Fronthead Latch Type
R75192	2720	Valve Bearing Stem	R98723	2745	Fronthead Wire Type 1 1/4
R75191	2719	Valve Bushing	R98703	2740	Fronthead Wire Type
R75190	2718	Valve	R5729	2712	Fronthead Bolt Spring
R45373	2737	Throttle Valve	R5721	2709	Fronthead Bolt Nut
R5754	2713	Throttle Valve Includes 2733	R5728	2744	Retainer Support 2 5/8 Dia.
R98368	2733	Throttle Valve "O" Ring	R76119	2722	Fronthead Bolt Lock Washer
R5717	2708	Throttle Valve Spring	R90584	2734	Fronthead Bolt Lock Washer
R75031	3369	Oil Plug Plain Handle	R86981	2727	Retainer Plunger
R560	2701	Oil Plug Rubber Grip Handle	R86982	2728	Retainer Plunger Spring
<b>CYLINDER</b>			R8999	2714	Retainer Bolt Nut
R530	3360	Air Inlet Swivel Nut	R76116	2721	Retainer
R40	2700	Piston	R76562	2723	Retainer Bolt Bushing
R85396	2726	Air Inlet Bushing	R5727	2731	Steel Retainer Spring
R85269	3390	Air Swivel	R76853	2724	Retainer Bolt
			R76935	2732	Spike Driver Dolly
			R98047	2742	Steel Retainer—Crust Breaker

